

KRM 40/25

Reduction adaptor, polyamide

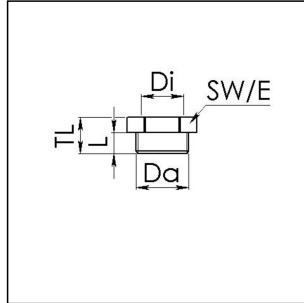

Product illustrations are exemplary and may differ from the chosen product. Further variants and individual customization, we will gladly provide you on request.



Material	Polyamide, fibre reinforced
Temp. range min	-40 °C
Temp. range max	100 °C
Thread type outer	M
Ø outer thread	40
Lead outer	1,5
Length screw-in thread L	12 mm
Thread type inner	M
Ø inner thread	25
Lead inner	1,5
Total length TL	19 mm
Key width SW	46 mm
Collar diameter (E)	51 mm
Product Color	RAL 7035
Order no. RAL 7035	10063587
Type	KRM 40/25
Packing unit	25
ETIM-Classification	EC000938

31.10.2016

