

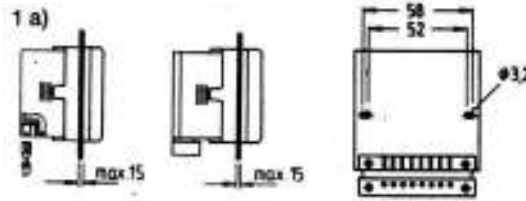

SYN 169
SUL 189
MEM 199
TM 179

Best.-Nr. Référence Order no. N° de pedido Art* No.	Nr. Articolo Codification Best.-Nr. Til. n:o
SYN 169 h	= 169 0 008
SYN 169 g	= 169 0 033
TM 179 h	= 179 0 008
SUL 189 h	= 189 0 008
SUK 189 g	= 189 0 033
MEM 199 h	= 199 0 008

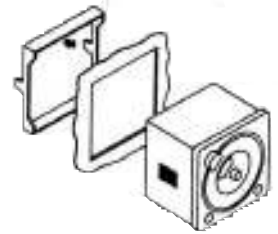
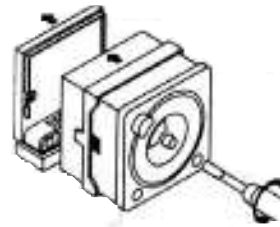
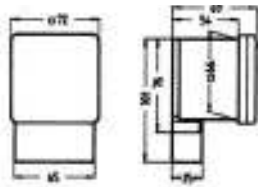

Richtlinie 91/157/EWG
Dieses Gerät enthält eine schadstoffhaltige Batterie. Der Endverbraucher ist zur ordnungsgemäßen Rückgabe des Gerätes verpflichtet.

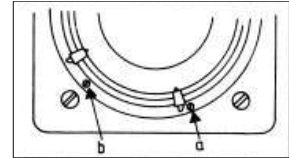

Mounting

- a) Panel mounting
- b) Surface mounting construction

Connections

The connections must conform with the appropriate installation specifications.

MOUNTING INSTRUCTIONS

Safety information:

Electrical devices should only be connected and mounted by an electrical specialist. Manipulations and modifications on the switch will result in loss of warranty. The national specifications and applicable safety regulations must be observed.

The time switches are in accordance with the European directives 73/23/EEC (Low-Voltage Directive) and 89/336/EEC (EMC-Directive). If the time switches are used together with other devices in an installation, take care that the complete installation does not cause a radio interference.

- 1) Synchronous drive starts immediately after c.t.p.s. (indicated at »a«).
- 2) When voltage is applied the quartz movement with approx. 3d (72 h) power reserve starts within a few minutes (indicated at »b«). The full power reserve is built up again after 3 days.

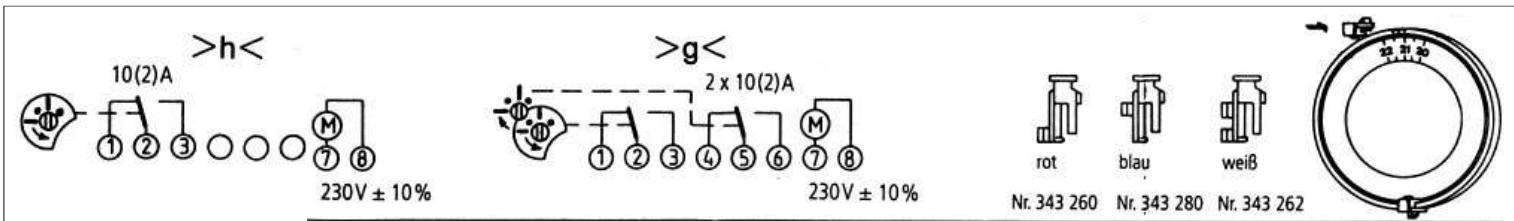

2) Connection, switch-rider functioning, setting of switching time.

>h< Switch rider red: ① ② on – ③ ④ off
Switch rider bleu: ② ③ on – ① ② off
if with this system a changeover is required only once every 24 h, a white rider (ref. 343 262) must be plugged in.

>g< Switch-rider blue: ① ② and ② ③ alternately on – off
Switch-rider red: ④ ⑤ and ⑤ ⑥ alternately on – off
Switch-rider white: ① ② ③ and ④ ⑤ ⑥ together or alternately on – off
With common actuation of both contacts by the white switch-rider, switching time differences of up to 5 minutes are possible with the 24-hour disc.

Shortest switching intervals:

- with 60 min. disc = ca. 1 min.
- with 24-h disc = 22.5 min.
- with 7-day disc = 3 h

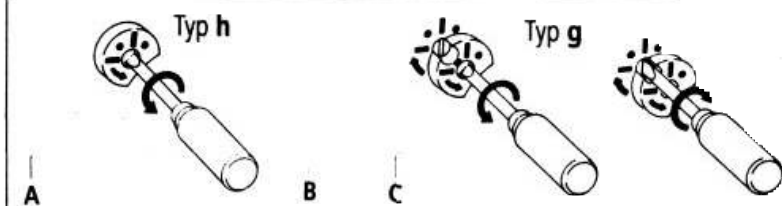
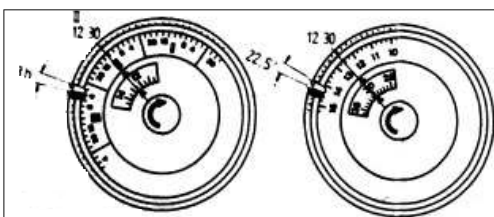

3) Setting the time

f.e. tuesday = II = 12.30 h

4) Switch-position >h<

Switch-axis A:
Contact ② ③ on – ① ② off
Contact ① ② on – ② ③ off

Switch-position >g<

Switch-axis position C as for >h<
Switch-axis B:
Contact ④ ⑤ on – ⑤ ⑥ off
Contact ④ ⑤ off – ⑤ ⑥ on

D **THEBEN AG**
Postfach 56
D-72394 Haigerloch
Telefon (0 74 74) 692-0
Telefax: (0 74 74) 692 150
Kundendienst
Telefon (0 74 74) 692-177
Telefax (0 74 74) 692-207
Domain im Internet:
<http://www.theben.de>

A **SIBLIK ELEKTRIK GES.M.B.H & CO.KG,**
Murbangasse 6,
1108 Wien,
Tel. 01/68006-0, Fax. 6800659

GB **TIMEGUARD LTD,**
Victory Park, 400 Edgware Road
London NW2 6ND
Tel. 0181/4508944;
Fax: 0181/4525143

CH **Theben (Schweiz) AG**
Schwettstrasse 152
CH-5704 Egliswil
Telefon 0 62 775 38 11
Telefax 0 62 775 38 12

AUS **PETER WARBURTON PTY. LIMITED,**
64 Britannia Road, Castle Hill
NSW 2154, Australia,
Tel.: (02) 9899 2908,
Fax: (02) 9899 4486