

# Ventilation - Accessories

## IN-LINE BACKDRAUGHT SHUTTER

Can be mounted onto the spigot of the 4"/5"/6" XF, XP, SF fans or In-Line in the ducting

Cat. No.	Description	Size
1230L	In-Line Backdraught Shutter	100mm/4"
1231L	In-Line Backdraught Shutter	120mm/5"
1232L	In-Line Backdraught Shutter	150mm/6"



## FIRE DAMPERS

Can be mounted vertically or horizontally, and have a one hour fire rating in both directions

Cat. No.	Description	Size
1261	Fusible Link Fire Damper	100mm/4"
1262	Fusible Link Fire Damper	120mm/5"
1263	Fusible Link Fire Damper	150mm/6"



## FIRE SEALS\*

For Flat Channel Ducting & Round Pipes

Cat. No.	Description	Size
FS110D	Fire Seal	110mm
FS150D	Fire Seal	150mm
FS204D	Fire Seal	204mm
FS220D	Fire Seal	220mm
FSC225	Fire Seal Cage	225mm
FSC300	Fire Seal Cage	300mm
FCL80	Fire Collar	80mm
FCL100	Fire Collar	100mm
FCL125	Fire Collar	125mm
FCL150	Fire Collar	150mm
FCR110	Rectangular Fire Collar	110x54mm
FCR204	Rectangular Fire Collar	204x60mm
FCR225	Rectangular Fire Collar	225x25mm
FCR300	Rectangular Fire Collar	300x25mm

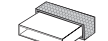
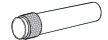

\* Manrose Manufacturing Ltd does not guarantee compliance with Building Regulations Part B, Fire Spread or other regulations that relate to fire planning. Suitability to comply with these regulations should be determined prior to installation and in conjunction with Building Control Officers. Compliance with the Regulations is specifically excluded from quotations and designs.

## DUCT KIT

400mm Wall Vent Kit for the WF Series / Aluminium Wall Liner

Cat. No.	Description	Size
1300	for WF150 Series	150mm/6"
1301	for WF230 Series	230mm/9"
1299	for WF300 Series	300mm/12"



## WALL VENT KITS

Kits complete with Aluminium Flexible Ducting and External Wall Grilles in White, Grey, Brown, Terracotta & Cotswold Stone (please state colour)



Cat. No.	Description	Size
1270	XFFK for XF 100 Range	100mm/4"
1271	XFFK for XF 120 Range	120mm/5"
1280	SVK for XF 150 Range	150mm/6"
1290	AVK for XF 150A Range	150mm/6"
1291	AVK for XFS 230 Range	230mm/9"
1292	AVK for XFS 300 Range	300mm/12"

## 1 WAY INTAKE/EXTRACT MOUNTING SPIGOT

Ancillaries for the commercial series

Cat. No.	Description	Size
1307	For Mannose 230mm (9") fans	230mm/9"
13071	For Mannose 300mm (12") fans	300mm/12"

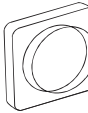

## 4 WAY SPIGOT ADAPTOR

Ancillaries for the commercial series

Cat. No.	Description	Size
1308	For Mannose 230mm (9") fans	230mm/9"
13081	For Mannose 300mm (12") fans	300mm/12"



## WINDOW VENT KITS

Full range of window conversion kits for the Mannose range of 4", 5" and 6" extractor fans

Cat. No.	Description	Size
1269	XF100 window vent kit	100mm/4"
12691	XF100A window vent kit	100mm/4"
1267	XF120 window vent kit	120mm/5"
12671	XF120A window vent kit	120mm/5"
1268	XF150 window vent kit	150mm/6"
12681	XF150A window vent kit	150mm/6"
1370	Extra long screws (55mm) for fitting fans in double glazed sealed units	
1374	For Fitting Window Fans in double glazed sealed units for 230mm (9") 300mm (12") double glazing screws	



# Ventilation - Accessories

## ROOF COWL TERMINATOR SET

Ancillaries for the commercial series

Cat. No.	Description	Size
1309	For Mannose 230mm (9") fans	230mm/9"
13091	For Mannose 300mm (12") fans	300mm/12"

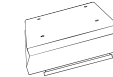

## EXTENSION SLEEVE

Extension Sleeve for walls from 380mm (15") to 533mm (21")

Cat. No.	Description
COMTK150ES	For 150 Series
COMTK230ES	For 230 Series
COMTK300ES	For 300 Series

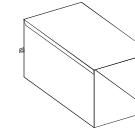

## CABLE

Cat. No.	Description
1302	5 Core Cable 2.5m
1303	5 Core Cable 5.0m
1304	5 Core Cable 10m
1305	5 Core Cable 25m



## SPARES

Cat. No.	Description
1310	TDI Replacement Timer Boards
1320	HSB Replacement Humidity Timer Board and Sensor
1321	As above but with twin speed control
1330	Replacement Motors For XF/XP/WF 100/120/150mm fans, for other models P.O.A
1340	Replacement Pullcord switches
1345	Extra Long Pullcord Switches



Extra Long Screws (55mm)

1370 For Fitting Window Fans in double glazed sealed units (3 per pack)

1374 For Fitting Window Fans in double glazed sealed units for 230mm (9") 300mm (12") double glazing screws

