

**Code:** 793X40

## Hartland | HARTLAND RANGE | Resistive Leading Edge Push On/Off Rotary 2 Way Switching Dimmers

### Product Image



### Wiring

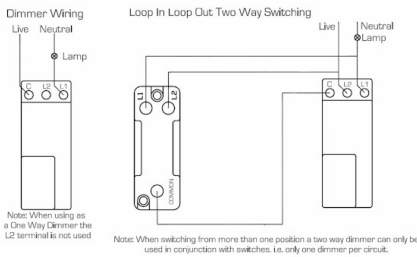

### Dimensions

**Hamilton®**  
HARTLAND  
3X40

Resistive Leading Edge Push On-Off Rotary  
2 Way Switching Dimmer

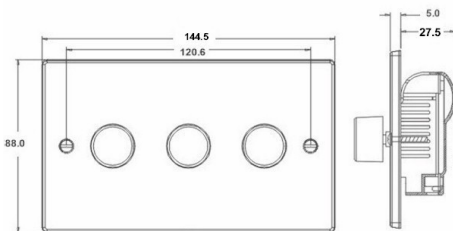

### Insert Type

3 gang 400w Resistive Leading Edge Push On/Off Rotary 2 Way Switching Dimmer

### Insert Colour

Antique Brass

### EAN13 Barcode

5017503299430

### Commodity Code

85365015

### Luckins TSI

386903708

### Dimensions(Nominal)

Double: Height = 88.0mm Width = 144.5mm Depth = 5.0mm

### Weight

291 GR

### Switched Poles

Single

### Current Rating

1.66 Amps per gang

### Voltage

230V AC

### Maximum Load

400W resistive per gang

### Mains Frequency

50Hz

### IP Rating

IP2XD

### Contact Gap Minimum

N/A

### Terminal Capacity 1

2x1mm<sup>2</sup>

### Terminal Capacity 2

2x1.5mm<sup>2</sup>

### Earth Terminal Capacity 1

5x1mm<sup>2</sup>

### Earth Terminal Capacity 2

4 x 1.5mm<sup>2</sup>

### Earth Terminal Capacity 3

3 x 2.5mm<sup>2</sup>

### Earth Terminal Capacity 4

1 x 4mm<sup>2</sup> Multi-strand

### Earth Terminal Capacity 5

1 x 6mm<sup>2</sup>

### Product Class 1

Face plate must be earthed

### Ambient Operating Temperature

-5° to +40°C

### Recommended Location

Internal Use Only

### Maximum Installation Altitude

2000m

### Standard/Approval

BS EN 60669-2-1

### Additional Notes

Tungsten filament GU10 lamps must be branded with a fuse base. When using mains voltage halogen lamps dimmers should be de-rated by 25%. When dimming LED lamps de-rated by 75% - please contact our Technical for compatibility.

R Hamilton & Co Ltd, Unit 10 Carrick Business Centre,  
4-5 Bonville Road, Brislington, Bristol, BS4 5NZ

T: +44 (0)1747 860088

E: [info@hamilton-litestat.com](mailto:info@hamilton-litestat.com) | W: [www.hamilton-litestat.com](http://www.hamilton-litestat.com)

All accessories are manufactured under an accredited BS EN ISO 9001:2015 Quality Management System. It is the policy of the company to improve products as part of our development programme. Therefore, we reserve the right to alter designs and dimensions without prior notice. Illustrations and diagrams are reproduced within the limitations of reproduction and printing process and are not binding. Due to manufacturing processes we cannot guarantee an exact colour match and shadings of certain finishes. This datasheet was generated on 2/24/2023 3:08:54 PM E&OE