



# ELECTRIC VEHICLE CHARGING

DOMESTIC ELECTRIC VEHICLE CHARGING SOLUTION

## FEATURES

- 3 pin plug to type 1 or 2 plug
- IP54 rated
- Charges at 10A, 2.3kW (average 8 miles range per charging hour)
- Available in 5 and 10 metre lengths
- LED charging status Indicator
- Can be stored in Masterplug branded carry case (part reference EVCASE)



## PRODUCT IMAGES



EV cable



Type 1 plug



Type 2 plug

## LINE DRAWING

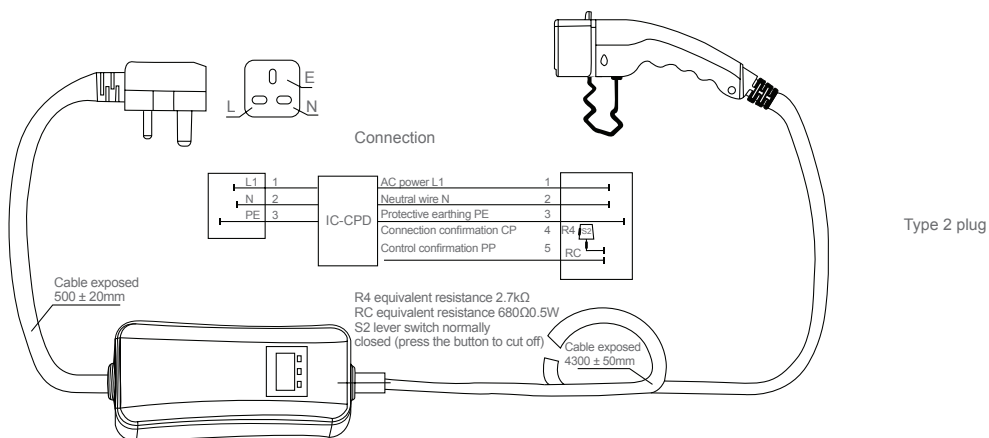
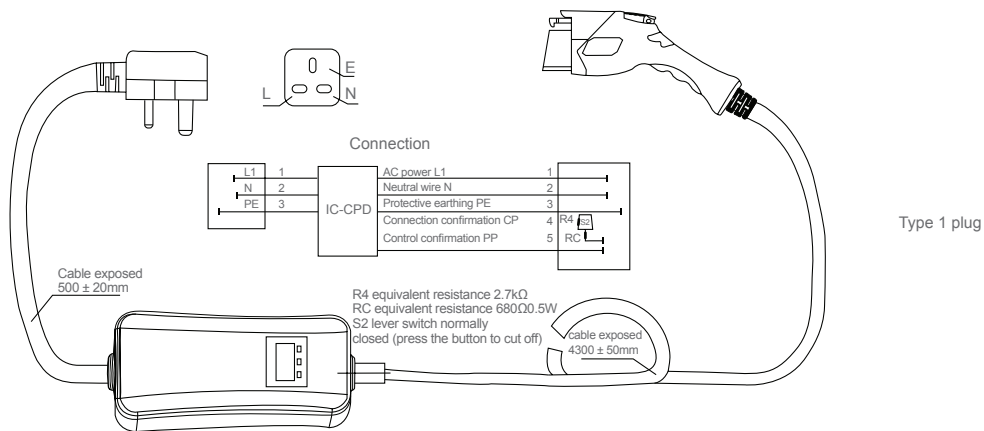



# ELECTRIC VEHICLE CHARGING

DOMESTIC ELECTRIC VEHICLE CHARGING SOLUTION

## PRODUCT INFORMATION

Part Number	EVCP1135SL	EVCP11310SL	EVCP2135SL	EVCP21310SL
Cable length	5 metre	10 metre	5 metre	10 metre
EV mode	2	2	2	2
Plug type (to power socket)	3 pin 13A domestic plug	3 pin 13A domestic plug	3 pin 13A domestic plug	3 pin 13A domestic plug
Plug type (to vehicle socket)	Type 1 (J1772)	Type 1 (J1772)	Type 2 (IEC62196)	Type 2 (IEC62196)

## TECHNICAL SPECIFICATIONS

Standard(s)	This product is certified to applicable British safety standards IEC 62196-2, UK BS 1363-2, CE, TUV	
Input	220-250V AC 60/60Hz 13A	
Charging output	220-250V AC 60/60Hz 10A	
IP rating	54	
Cable colour	Green	
Plug colour	White	
Rated current	10A (as per safety regulation defined in mode 2)	
Rated voltage	120v/240V	
Resistance voltage	2000V	
Insulation resistance	>1000M	
Contact resistance	less than 0.5m	
Material	Thermo plastic/silicon rubber/copper alloy	
Insertion and extraction force	80N<F<100N	
Mechanical life	>10000 times	
Fire rating	UL94 V-0	
Ip rating	IP54	
Operating temperature	-30 to 50 degrees Celsius	
Cable specification	3 x 2.5mm <sup>2</sup> / 6mm <sup>2</sup>	

IF IN DOUBT CONSULT A QUALIFIED ELECTRICIAN

## EV MODE 2 DEFINITION

Mode 2 (AC) uses a standard domestic 3 pin socket and cable with a control pilot function and system of protection against electric shock. An entry level charging solution for domestic applications.

Masterplug Help Line  
**03300 249 279**

Supplied by  
**Lucoo PLC**  
Stafford Park 1 Telford TF3 3BD ENGLAND

Visit our website at  
**www.masterplug.com**



# ELECTRIC VEHICLE CHARGING

DOMESTIC ELECTRIC VEHICLE CHARGING SOLUTION

## EV TYPE 1 AND 2 DEFINITION

### Type 1

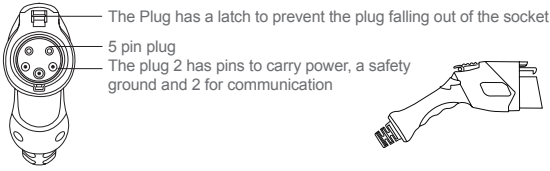

Type 1 is widely used in US and Japanese vehicles

Has round housing, which has a notch on the vehicle inlet for proper orientation

Uses five pin-and-sleeve contacts for two AC conductors, a protective conductor and two signal pins that are used for the control pilot function (according to IEC 61851-1 Annex A) and for proximity detection (using an auxiliary switch and no current coding, according to IEC 61851-1 Annex B)

When inserted into the vehicle inlet, the connector is held in place by a mechanical latch, which is part of the connector.

### Type 2

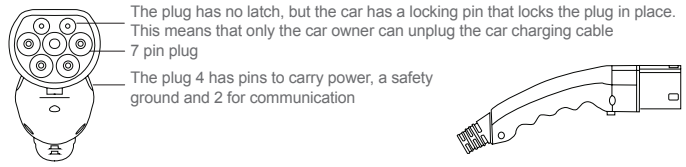

Type 2 is widely used for European vehicles

Has round housing, which is flattened on one side for proper orientation

Uses seven pin-and-sleeve contacts for up to four AC conductors, a protective conductor and two signal pins that are used for the control pilot function (according to IEC 61851-1 Annex A) and for simultaneous proximity detection and current coding (according to IEC 61851-1 Annex B)

By design, the contacts can not be touched by the standardized test finger. When inserted into the inlet, the connector is held in place by the locking mechanism, which is attached to the inlet. The same concept is used by the socket-outlet to hold the plug in place.

## OPERATING INSTRUCTIONS

1. Insert 3 pin plug to power outlet
2. Wait for LED display to indicate Ready (solid green LED)
3. Connect type 2 (IEC 62196-2) or type 1 (SAE J1772) plug to your vehicles socket
4. Allow 30 seconds for communication with vehicle to take place (slow flashing green LED)
5. Check LED charging indicator is illuminated (pulsing green and solid red LED)
6. Once charge is complete all LED's will turn off

To end charging before charging is complete remove plug from the power outlet and then vehicle

If a fault is detected (yellow LED illuminated), unplug from vehicle and the power outlet then wait 30 seconds and reconnect

If you need further assistance you can get in touch with our technical helpline on **+44 (0)3300 249 279**

Email : [technical.support@bgelectrical.uk](mailto:technical.support@bgelectrical.uk)

## SAFETY WARNING

**BEFORE USE PLEASE READ CAREFULLY AND USE IN ACCORDANCE WITH THE OPERATING INSTRUCTIONS AND THE VEHICLES CHARGING INSTRUCTIONS**

**DO NOT USE IF ANY PART OF THE EQUIPMENT IS DAMAGED**

## ENVIROMENTAL PROTECTION

Waste electrical products should not be disposed of with household waste. Please recycle where facilities exist. Check with your Local Authority or retailer for recycling advice.



Masterplug Help Line  
**03300 249 279**

Supplied by  
**Luceco PLC**  
Stafford Park 1 Telford TF3 3BD ENGLAND

Visit our website at  
**[www.masterplug.com](http://www.masterplug.com)**